

**PRODUCT INFORMATION**

Size mm	Product code	Type	Max fixture thickness	Hole diameter	Screw size (d x L)	Quantity	
			mm	mm	mm	Items per box pcs	
10 x 80	R-FF1-N-10L080-A4		10	10	7 x 89	50	
10 x 100	R-FF1-N-10L100-A4		30	10	7 x 109	25	
10 x 120	R-FF1-N-10L120-A4		50	10	7 x 129	25	
10 x 140	R-FF1-N-10L140-A4		70	10	7 x 149	25	
10 x 160	R-FF1-N-10L160-A4		90	10	7 x 169	25	
10 x 200	R-FF1-N-10L200-A4		130	10	7 x 209	25	
10 x 240	R-FF1-N-10L240-A4		170	10	7 x 249	25	
10 x 300	R-FF1-N-10L300-A4		230	10	7 x 309	10	
8 x 80	R-FF1-N-08L080			10	8	5.8 x 87	50
8 x 100	R-FF1-N-08L100			30	8	5.8 x 107	50
8 x 120	R-FF1-N-08L120			50	8	5.8 x 127	50
10 x 80	R-FF1-N-10L080/G			10	10	7 x 89	50
10 x 100	R-FF1-N-10L100/G			30	10	7 x 109	25
10 x 120	R-FF1-N-10L120/G			50	10	7 x 129	25
10 x 140	R-FF1-N-10L140/G			70	10	7 x 149	25
10 x 160	R-FF1-N-10L160/G			90	10	7 x 169	25
10 x 200	R-FF1-N-10L200/G			130	10	7 x 209	25
10 x 240	R-FF1-N-10L240/G			170	10	7 x 249	25
10 x 300	R-FF1-N-10L300/G			230	10	7 x 309	10
10 x 80	R-FF1-N-10L080/DT			10	10	7 x 89	50
10 x 100	R-FF1-N-10L100/DT			30	10	7 x 109	25
10 x 120	R-FF1-N-10L120/DT			50	10	7 x 129	25
10 x 140	R-FF1-N-10L140/DT			70	10	7 x 149	25
10 x 160	R-FF1-N-10L160/DT			90	10	7 x 169	25
10 x 200	R-FF1-N-10L200/DT			130	10	7 x 209	25
10 x 240	R-FF1-N-10L240/DT			170	10	7 x 249	25
10 x 300	R-FF1-N-10L300/DT			230	10	7 x 309	10
10 x 80	R-FF1-N-10K080/G			10	10	7 x 89	50
10 x 100	R-FF1-N-10K100/G			30	10	7 x 109	25
10 x 120	R-FF1-N-10K120/G			50	10	7 x 129	25
10 x 140	R-FF1-N-10K140/G	70		10	7 x 149	25	
10 x 160	R-FF1-N-10K160/G	90		10	7 x 169	25	
10 x 200	R-FF1-N-10K200/G	130		10	7 x 209	25	
10 x 240	R-FF1-N-10K240/G	170		10	7 x 249	25	
10 x 300	R-FF1-N-10K300/G	230		10	7 x 309	10	
10 x 80	R-FF1-N-10K080/DT	10		10	7 x 89	50	
10 x 100	R-FF1-N-10K100/DT	30		10	7 x 109	25	
10 x 120	R-FF1-N-10K120/DT	50		10	7 x 129	25	
10 x 140	R-FF1-N-10K140/DT	70	10	7 x 149	25		
10 x 160	R-FF1-N-10K160/DT	90	10	7 x 169	25		
10 x 200	R-FF1-N-10K200/DT	130	10	7 x 209	25		
10 x 240	R-FF1-N-10K240/DT	170	10	7 x 249	25		
10 x 300	R-FF1-N-10K300/DT	230	10	7 x 309	10		
10 x 80	R-FF1-N-10K080-A4	10	10	7 x 89	50		
10 x 100	R-FF1-N-10K100-A4	30	10	7 x 109	25		
10 x 120	R-FF1-N-10K120-A4	50	10	7 x 129	25		
10 x 140	R-FF1-N-10K140-A4	70	10	7 x 149	25		
10 x 160	R-FF1-N-10K160-A4	90	10	7 x 169	25		
10 x 200	R-FF1-N-10K200-A4	130	10	7 x 209	25		
10 x 240	R-FF1-N-10K240-A4	170	10	7 x 249	25		
10 x 300	R-FF1-N-10K300-A4	230	10	7 x 309	10		
14 x 120	R-FF1-N-14K120	50	14	10.8x131	20		
14 x 160	R-FF1-N-14K160	90	14	10.8x171	20		
14 x 200	R-FF1-N-14K200	130	14	10.8x200	20		

**INSTALLATION GUIDE**

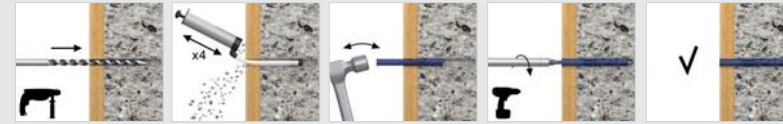

1. Drill a hole of required diameter and depth.
2. With a hammer, lightly tap the plug through the fixture into hole until fixing depth is reached.
3. Tighten the FF1 screw.



Ready installed product (hexagonal head version).

**BASE MATERIAL**

- Concrete C12/15-C50/60
- Solid Brick
- Solid Sand-lime Brick
- Hollow Sand-lime Brick
- Hollow Brick
- Hollow Lightweight Concrete Block
- Aerated Concrete Block



Rawlplug Ltd  
Skibo Drive  
Thornliebank Industrial Estate  
Glasgow G46 8JR

Tel: +44 (0) 141 6387 961  
Fax: +44 (0) 141 6387 397  
rawlinfo@rawlplug.co.uk  
www.rawlplug.co.uk

RM-LR-FF1-EN

**FF1**

**“VERSATILITY AND EFFICIENCY**

With the best corrosion protection



Universal Frame Fixing

Trust & Innovation

# "RANGE ADJUSTED TO NEEDS

Versatility  
of applications



## UNIVERSAL PLUG

Our innovative fixing ensures correct installation in a variety of substrates including both solid and hollow substrates. You no longer need to select the correct screw for a specific substrate as the FF1 line of fixings is ETA-certified for use in a number of substrate types. It also offers one of the highest load bearing parameters available on the market. And thanks to its two anchoring depths, you get more flexibility in selecting the right solution for your application.

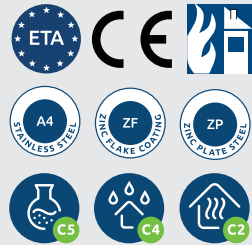

Hexagonal head with collar  
Plug with collar



Countersunk head,  
Countersunk plug

# FEATURES AND BENEFITS

**3 types of screw:**  
- carbon steel zinc plated  
- carbon steel zinc flake coated  
- A4 stainless steel

**2 types of head:**  
hexagonal with collar  
and countersunk  
with T30 or T40 recess

**Unique design ensures  
the highest parameters  
in a wide range of  
substrates according to  
ETAG 020 (A, B, C, D)**

**Internal plug  
geometry**  
designed to fit the  
screw head

**Nylon plug with  
4 way expansion**

**Two anchoring depths - 50 /  
70mm** for flawless installation  
in a variety of substrates

## "VERSATILITY

The advanced design of the expansion zone consists of 3 separate zones working in different ways. The design of each assumes interaction with a different type of substrate while the combination of them all has allowed us to obtain the most versatile and universal frame fixing on the market.

## SAFETY

FF1 is Rawlplug's flagship product in the lightweight fixings category, which has been designed in accordance with our 100 years of experience in manufacturing and using of fixings and fasteners. We really do know how to create a product that will perform impressively not only during laboratory tests, but also on the most challenging building sites.

## PARAMETERS

2 anchoring depths, 3 diameter options, 2 types of heads and a range of length options allow you to choose the optimum solution for every application and any fixed element. It also allows you to install securely thanks to the FF1's excellent load-bearing capacity and installation parameters.

## CORROSION PROTECTION

The multitude of applications in which our products are used requires a unique approach to corrosion protection. This is why, we offer a variety of coatings - from galvanic zinc to A4 steel, including the latest zinc-flake inorganic coating, with a certified 1500 hours of resistance during tests in a salt chamber. You won't find a coating like this or frame fixing like FF1 anywhere else! Plus, its carbon steel type can be used for fixing ventilated facades with a bitumen coating.

## VERSATILITY AND EFFICIENCY

THE BEST CORROSION PROTECTION

